

Assembly Manual

Flashlight on a pole (7091.75)

Introduction

Foreword

The installation procedures described in this assembly manual should only be undertaken by a Hako service centre or a workshop authorised by Hako. Members of staff with the required level of training and expertise are only guaranteed in the said workshops. This assembly manual may be used only in conjunction with the instruction manual of the machine.

Safety instructions

Please observe the general safety regulations of the corresponding machine in the relevant operating manual. Place the machine on a level surface and secure it with the parking brake. Switch the machine off and pull out the key.

We would expressly advise you that no legal claims may be asserted based on the contents of this manual. In the case of necessary repair work, please make sure that only original spare parts are used. Only original spare parts guarantee constant and reliable operational readiness of your machine. We reserve the right to make changes in the interests of further technical development.

Valid as from: June 2017

Hako GmbH
23843 Bad Oldesloe, Germany
Hamburger Str. 209-239
Phone +49 4531 806-0

1 Flashlight on a pole

1.1 Parts list

- 1 1x flashlight, pre-assembled
- 2 1x hex bolt M8x40
- 3 1x washer 8.4
- 4 1x bushing
- 5 2x O-rings
- 6 2x hex nuts M4
- 7 1x plate
- 8 2x sheet metal screws 3.5x9.5
- 9 Drilling template

- Cable loom W65 (not shown)
- Assembly manual

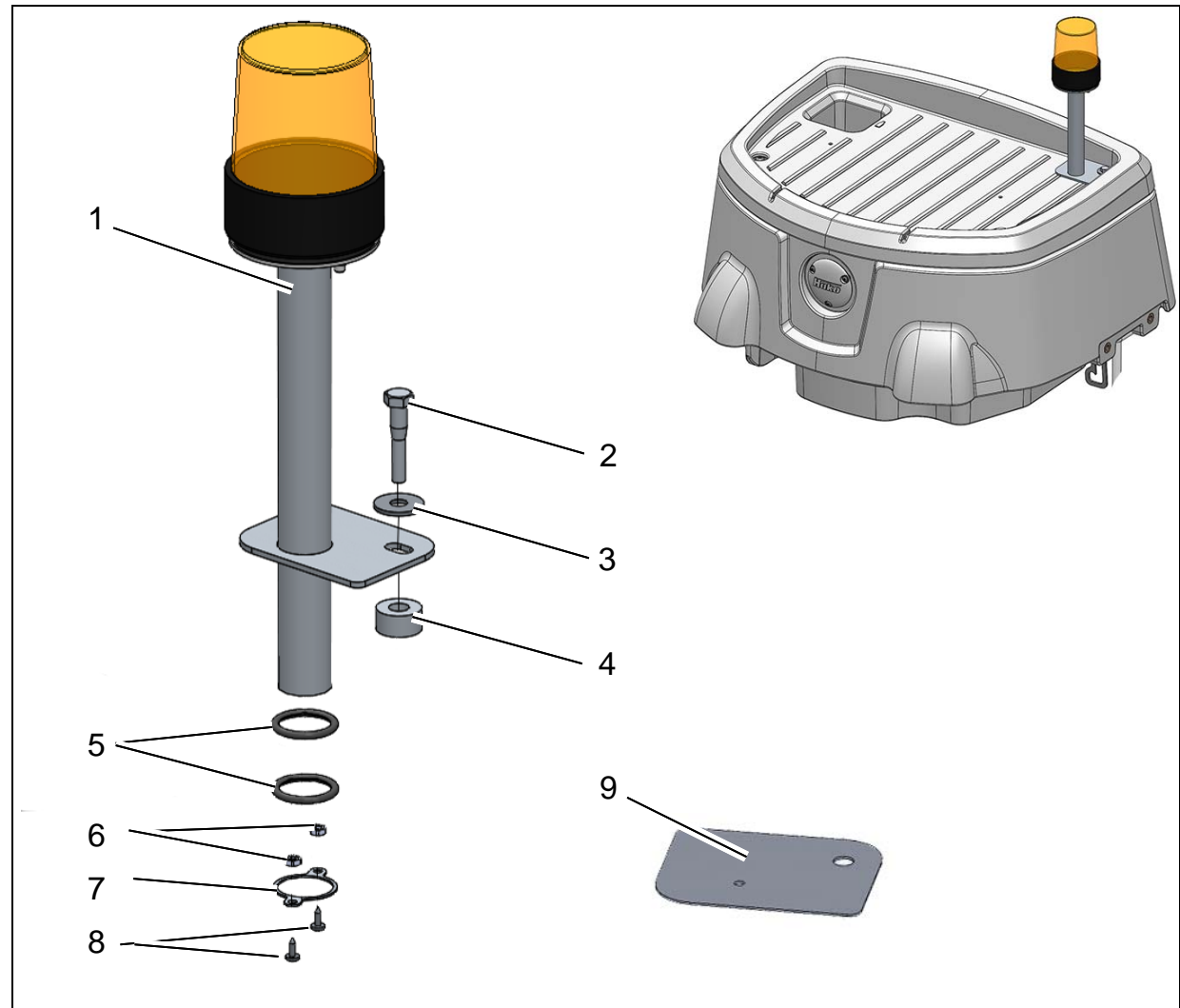

Fig. 1

Flashlight on a pole

1.2 Preparatory work

1. Remove fastening screw and washer of cover at flashlight installation location (Fig. 2/1)
2. Fit drilling template with screw, washer and bushing (Fig. 2/2)



Ensure that the drilling template is in the correct position!

3. Pre-drill a hole 4 mm in diameter and 25 mm deep using the drilling template.
4. Remove drilling template.
5. Remove remaining 3 fastening screws and washers of top cover and remove top cover.
6. Enlarge 4 mm diameter pre-drilled hole with 27 mm diameter drill bit.
7. Remove chips.

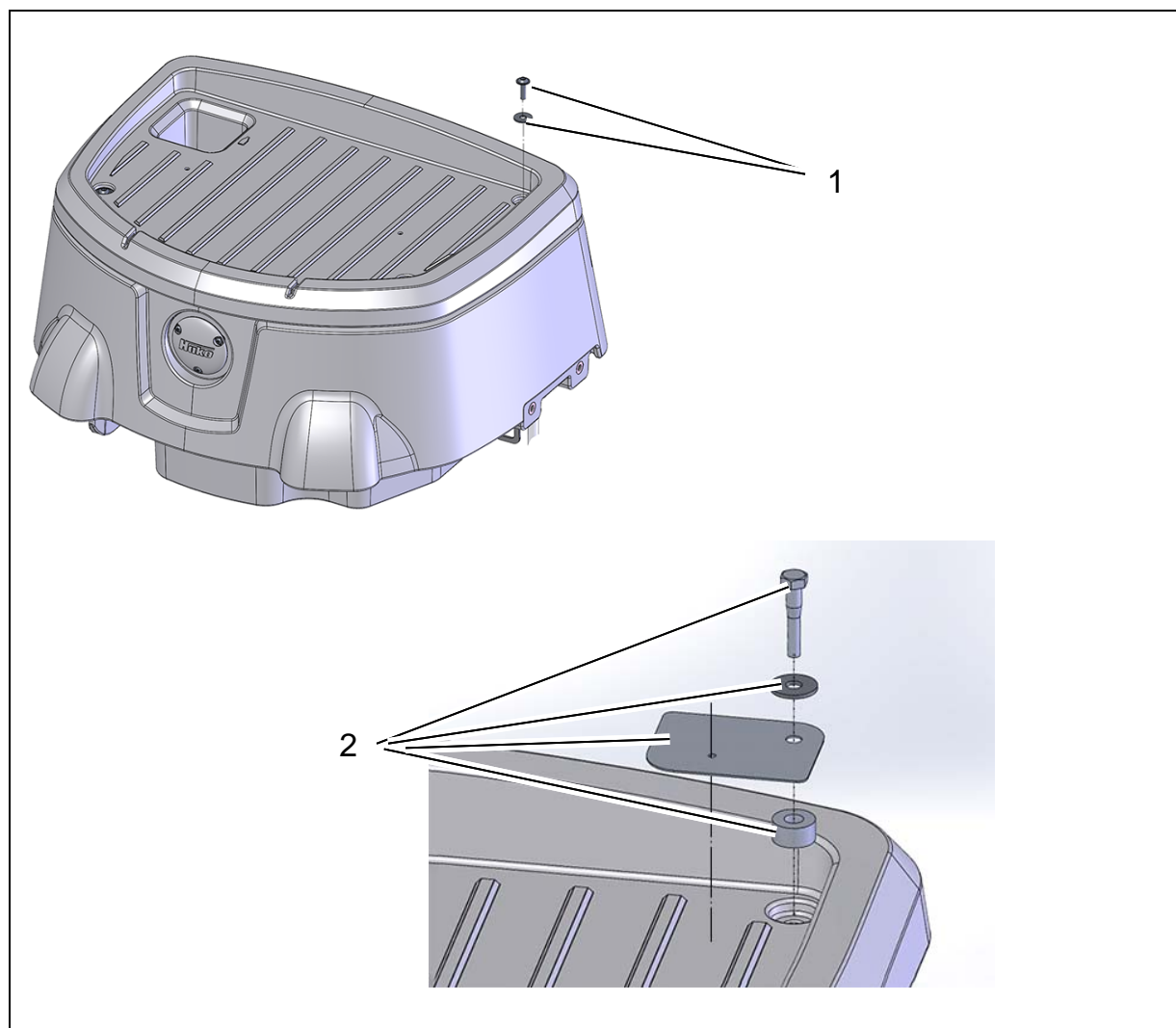

Fig. 2

1.3 Mounting

1. Fit flashlight as shown in illustration.
2. Secure inner O-ring with plate. To do this, align sheet metal screws with spacer nuts (Fig. 3/1) and screw in by hand.
3. Connect connector X48 of cable loom W65 of flashlight to connector X48 of cable loom W10 (Fig. 3/2).
4. Fit top cover.
Screw tightening torque: 10 Nm.

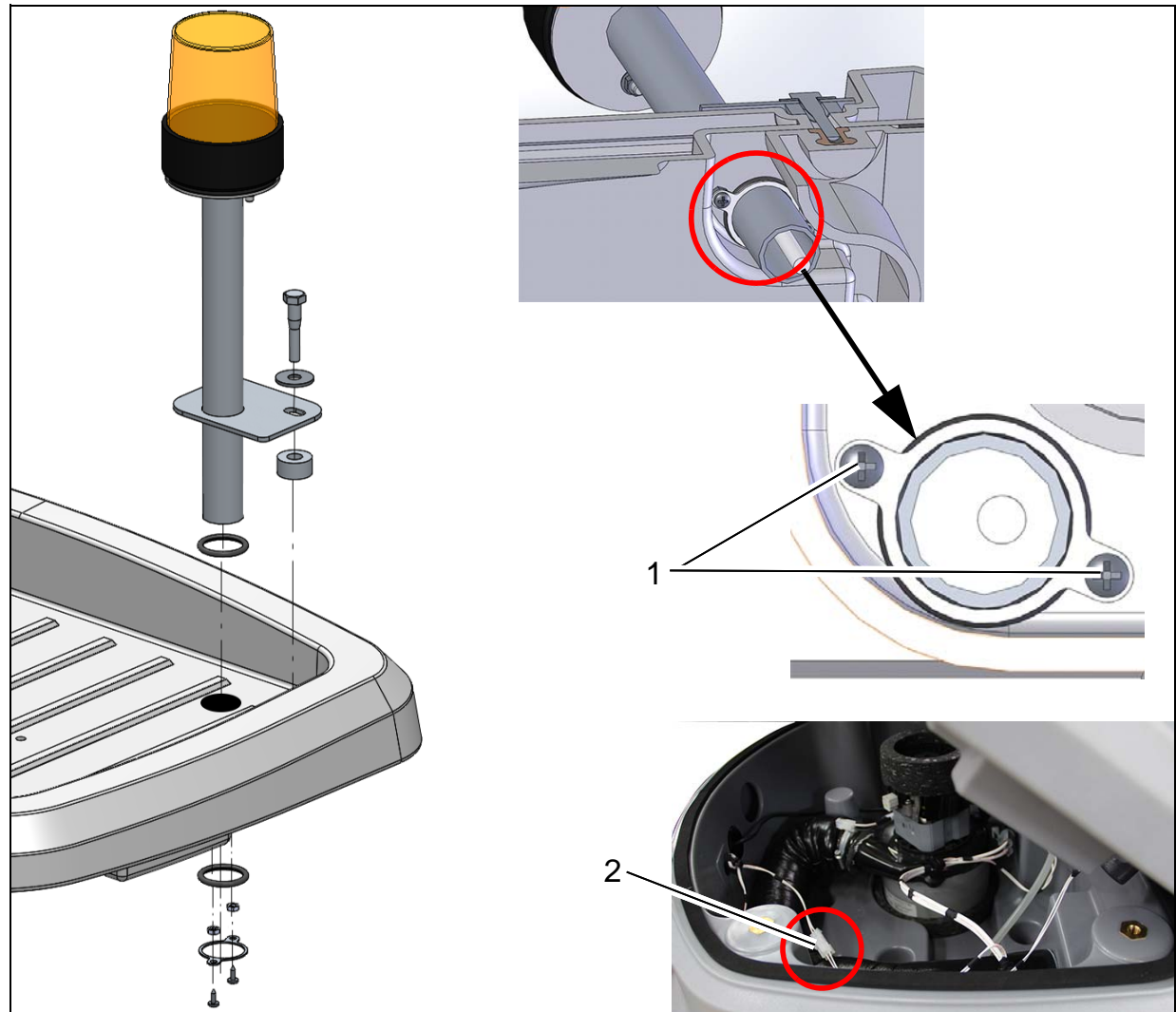

Fig. 3



Advanced Technology for a Cleaner, Better Environment

88-10-3119 - 3766-00



Hako GmbH ▪ Head Office ▪ Hamburger Str. 209-239 ▪ 23843 Bad Oldesloe ▪ Germany
Phone +49 4531 806-0 ▪ Fax +49 4531 806-338